

CERTIFIED RECORD OF LAND CORNER MONUMENTATION

History of original corner establishment: \*

The original corner was set in 1881 by Robb and Gradon under Contract No. 383, dated March 26, 1881.

The original notes state:

N89°46'W on true line on North boundary Sec 6  
 40.00 Set stone 13x10x6 for 1/4 sec cor from which  
     A pine 10 ins dia bears N 70 W 38 lks dist  
     A pine 4 ins dia bears S 50° E 27 lks dist

DIAGRAM

T9S R32E  
 S31  
 1/4---  
 S6

Description of corner evidence found:

Found a 13x10x6" stone marked 1/ and a partial 4 in a mound of stone.

Description of monument and accessories I establish to perpetuate the original location of this corner:

Set a 2 1/2"x28" aluminum monument 22" in the ground in a mound of stone and buried the original stone on the North side.

I establish new bearing trees:

A 9" Fir bears N 69-3/4° E, 29.1 ft, scribed 1/4S31BT.  
 A 7" Fir bears S 72° E, 18.6 ft, scribed 1/4S6BT.

T9S R32E  
 S31  
 1/4---  
 S6  
 T10S  
 PLS1918  
 1988

New BTs have 3/4" brass washers marked PLS1918 attached to the BT blaze, faces and bands painted with red tree marking paint, and BT tags and Attention or Land Survey Monument signs. A steel fence post with Attention or Land Survey Monument sign is driven approximately 3-5 feet from the corner.

Sun Cadastral Survey, Cont No. 53-04H1-7-4011  
 Field Book: 4-38, 6-24 & 6-28  
 Work accomplished: 8/30/88  
 Witnesses: Louise Parsons, Douglas Parsons  
 Job No.: 87221

PARSONS SURVEYING  
 1915 S.E. Stone Street  
 Corvallis, OR 97333  
 (503) 752-7515

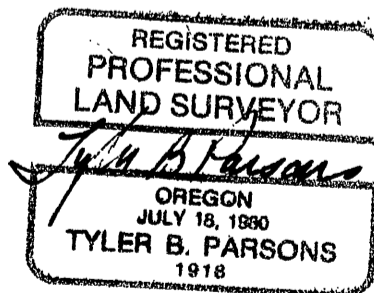

Office of COUNTY SURVEYOR County of GRANT  
 State of OREGON, I hereby certify that the within instrument was filed in this office  
 for record on the 7<sup>th</sup> day of Feb, 19 87

Robert D. Bepp by \_\_\_\_\_  
 (COUNTY OFFICIAL) (DEPUTY)